

## 6" HYDRAULIC SUBMERSIBLE TRASH PUMP

### MODEL S6TC

6" (150 mm) Discharge

The S6TC is a 6" discharge trash pump designed specifically to easily pass through a 22" manhole. The S6TC is offered in your choice of two motor displacements to cover a wide range of hydraulic input flows. This pump is the most versatile 6" solids handler in our line.



## FEATURES

- High Efficiency 2 Vane Closed Channel Impeller (will Pass 3" (75 mm) Semi-Solids)
- Compact (Will Fit Through a 21" Opening)
- Oil Lubricated Seals (Can Run Dry)
- Variable Speed Hydraulic Drive
- Adjustable Wear Ring
- Can Be Bolted Directly Inline or Staged
- Safe Hydraulic Drive Can Be Used Where Electric Power is Hazardous or Impractical
- Dependable Gear Type Hydraulic Motor
- Operates With Our HT35 to HT60 Power Units or Other Hydraulic Power Sources with hydraulic flows up to 28 GPM

## SPECIFICATIONS

|                                 |   |
|---------------------------------|---|
| WEIGHT:.....                    | 255 lbs. (116kg)                                |
| HEIGHT:.....                    | 34" (86 cm)                                     |
| DIAMETER (@ widest point):..... | 20-3/4" (53 cm)                                 |
| DISCHARGE:.....                 | 6" NPT(F)                                       |
| INLET FLANGE:.....              | 6" 125# ANSI                                    |
| SOLIDS HANDLING:.....           | 3" (75 mm)                                      |
| HOSE PORTS:.....                | 1" S.A.E. Straight Thread                       |
| PUMP BODY:.....                 | Ductile Iron                                    |
| IMPELLER:.....                  | Ductile Iron                                    |
| WEAR RING.....                  | Ductile Iron                                    |
| SHAFT:.....                     | 17-4 PH Stainless Steel                         |
| SHAFT SEAL:.....                | Carbon / Ceramic (Std)<br>Silicon Carbide (Opt) |
| ELASTOMERS:.....                | Buna N (Std)                                    |
| HYDRAULIC OIL:.....             | 214-320 s.s.u. @ 100°F (64°C)                   |
| INPUT FLOW:.....                | Max. 28 GPM (106 LPM)                           |
| OPERATING PRESSURE:..           | Max 2900 PSI (197 Bar)                          |
| POWER SOURCE:..                 | Any Open Center Hydraulic System                |

A0601

Specifications subject to change without notice.

## Model S6TC Overall Dimensions

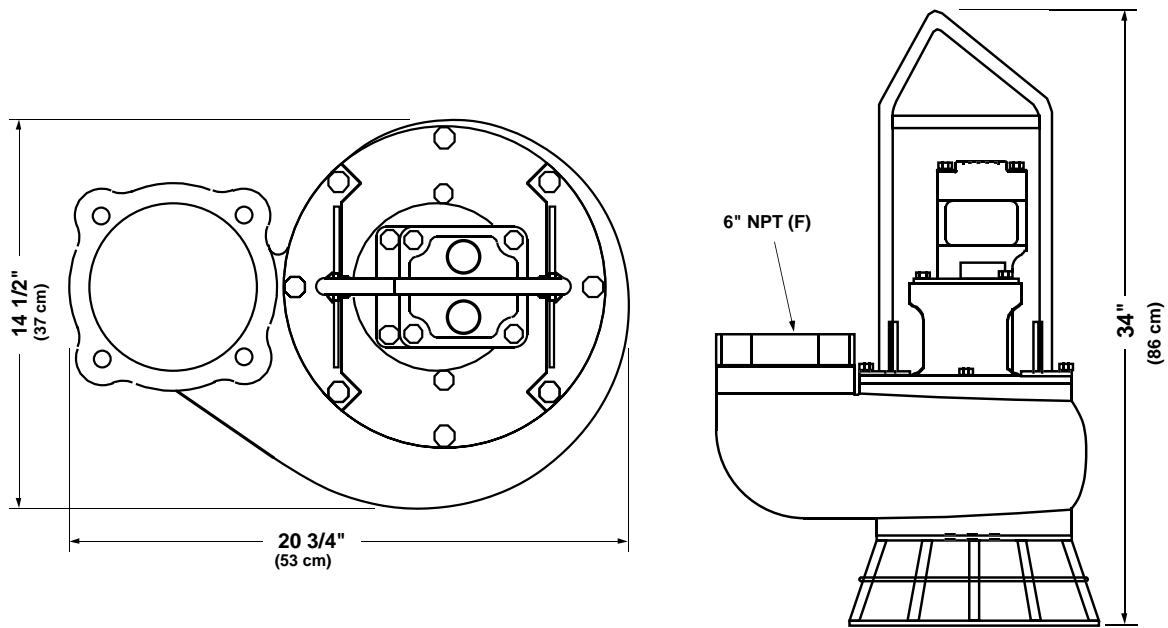

## S6TC Typical Performance

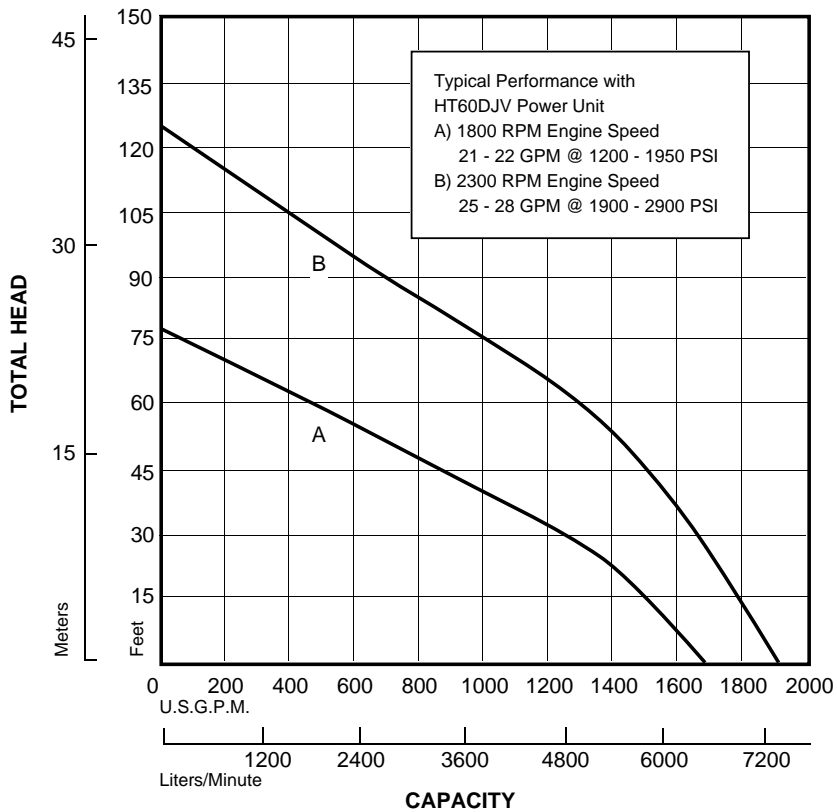

Curves are based on pumping water at 60° F. For Performance Curves other than shown above, Consult Factory.